

- | No | Name | Part |
|-----|------------------------------------|-----------------------|
| 1 | WHEEL COVER | WR6006-1600-300-21 |
| 2 | Ø10*Ø20*1.5 GASKET | GB845-85 |
| 3 | PRESS PLATE | WR6006-1600-700-13 |
| 4 | FRONT WHEEL SPINDLE ASSEMBLY | WR6006-1600-400-08 |
| 5 | 200 WHEEL | WR6006-1600-300-20 |
| 6 | FRONT DECORATIVE PANEL | WR6006-1600-300-05 |
| 7 | FILTER SPONGE NO.2 | WR6006-1600-700-08 |
| 8 | FILTER SPONGE NO.1 | WR6006-1600-700-07 |
| 9 | FILTER SPONGE NO.3 | WR6006-1600-700-09 |
| 10 | NUT 12*12*6 | M8 GB845-85 |
| 11 | PRESS PLATE | WR8001-1400-300-24 |
| 12 | BREAKWIND | WR6006-1600-300-13 |
| 13 | HOUSING COVER | WR6006-1600-300-02 |
| 14 | HOUSING HANDLE | WR6006-1600-300-04 |
| 15 | GRASS BAG FIXING PIN | WR6006-1600-300-17 |
| 16 | SPRING | WR6006-1600-400-04 |
| 17 | GRASS BAG COVER | WR6006-1600-300-03 |
| 18 | TORSION SPRING FIXING PIN | WR6006-1600-300-16 |
| 19 | PROTECTOR 17AMD 110Z+PTC | WR5001-1500-500-02 |
| 20 | SANDBAG | WR6006-1600-300-22 |
| 21 | BASE | WR6006-1600-300-01 |
| 22 | BACK WHEEL SPINDLE | WR6006-1600-400-03 |
| 23 | SCREW ST5*25 | GB845-85 |
| 24 | 150 WHEEL | WR6002-1500-300-03 |
| 25 | WHEEL COVER | WR8018-1500-300-12 |
| 26 | NUT M6*5 | GB845-85 |
| 27 | NUT M5 | GB845-85 |
| 28 | BEARING BLOCK | WR6006-1600-300-08 |
| 29 | NUT M5*25 | GB845-85 |
| 30 | INNER HEXAGON SPANNER | GB845-85 |
| 31 | PRESS PLATE | WR6006-1600-300-09 |
| 32 | NUT M6*30 | GB845-85 |
| 33 | DEPTH ADJUST HANDLE (RIGHT) | WR6006-1600-300-07 |
| 34 | DEPTH ADJUST HANDLE (LEFT) | WR6006-1600-300-06 |
| 35 | SCREW ST4*16 | GB845-85 |
| 36 | R PIN Ø2*20MM | GB845-85 |
| 37 | GRASS COLLECT FRAME | WR6006-1600-700-06 |
| 38 | GRASS COLLECT BAG | WR6006-1600-700-10 |
| 39 | SCREW ST4*20 | GB845-85 |
| 40 | SCREW ST5*25 | GB845-85 |
| 41 | FAST LOADING WRENCH | WR8001-1400-300-35 |
| 42 | QUICK MOUNT WRENCH CYLINDRICAL NUT | GB845-85 |
| 43 | QUICK LOAD WRENCH GASKET | WR8001-1400-300-36 |
| 44 | NO.2 ROD | WR6006-1600-700-04 |
| 45 | CABLE STRAIN RELIEF | WR8001-1400-300-23 |
| 46 | CABLE CLAMP | WR6006-1600-300-19 |
| 47 | NO.1 ROD SEAT | WR6006-1600-300-11 |
| 48 | NO.1 ROD | WR6006-1600-700-03 |
| 49 | SCREW ST5*14 | GB845-85 |
| 50 | SCREW M8*50 | GB845-85 |
| 51 | SCREW M8*50 | GB845-85 |
| 52 | SWEEPING FRONT BAFFLE | WR6006-1500-700-16 |
| 53 | SWEEPING BACK BAFFLE | WR6006-1500-700-17 |
| 54 | RING Ø8 | GB845-85 |
| 55 | MOTOR FAN | WR6001-1500-300-14 |
| 56 | SCREW ST3*12 | GB845-85 |
| 57 | CARBON BRUSH | WR8001-1400-600-01 |
| 58 | CARBON BRUSH HOLDER | WR8001-1400-600-02 |
| 59 | HOUSING | WR6001-1500-300-13 |
| 60 | STATOR ASSEMBLY | WR5006-1600-200 |
| 61 | SCREW ST4*65 | GB845-85 |
| 62 | BEARING 609-2RS | GB/T276-1994 |
| 63 | ROTOR ASSEMBLY | WR5006-1600-100 |
| 64 | BEARING 6900-2RS | GB/T276-1994 |
| 65 | GASKET Ø10.1*22*0.5 | WR6001-1500-700-13-01 |
| 66 | WCOL FELT Ø8*Ø16*1.5 | WR6001-1500-700-12 |
| 67 | GEAR BOX | WR6001-1500-400-09 |
| 68 | BEARING HK0608 | GB/T276-1994 |
| 69 | RING Ø10 | GB845-85 |
| 70 | WHEEL | WR6001-1500-400-07 |
| 71 | CENTRE FRAME | WR6006-1600-300-14 |
| 72 | SCREW ST4*20 | GB845-85 |
| 73 | SCREW M4*20 | GB845-85 |
| 74 | SCREW ST5*25 | GB845-85 |
| 75 | OUTPUT AXIS | WR6006-1600-400-06 |
| 76 | BELT | |
| 77 | CENTRE FRAME COVER | WR6006-1600-300-15 |
| 78 | NUT GB845-85 | |
| 79 | BEARING 609-2RS | GB/T276-1994 |
| 80 | WHEEL | WR6001-1500-400-18 |
| 81 | BEARING 6002-2RS | GB/T276-1994 |
| 82 | GASKET | GB845-85 |
| 83 | AXIS | WR6006-1600-400-07 |
| 84 | SCREW ST4*20 | GB845-85 |
| 85 | SCREW ST4*18 | GB845-85 |
| 86 | SCREW ST5*25 | GB845-85 |
| 87 | SWITCH ASSEMBLY | |
| 88 | TRIGGER SEAT LEFT | WR6007-1840-300-18 |
| 89 | SPRING | WR6007-1840-400-09 |
| 90 | WIRE CONNECTED ROD | WR6007-1840-300-20 |
| 91 | TRIGGER SEAT RIGHT | WR6007-1840-300-19 |
| 92 | SCREW ST4*25 | GB845-85 |
| 93 | SWITCH BOX PRESS PLATE | WR6007-1840-300-15 |
| 94 | SWITCH BOX LEFT | WR6007-1840-300-13 |
| 95 | WIRE | WR5006-1600-500-01 |
| 96 | PLUG | WR5006-1600-500-02 |
| 97 | CABLE SLEEVE | WR8001-1400-300-25 |
| 98 | ROCKER SWITCH | |
| 99 | SPRING | WR8001-1400-400-29 |
| 100 | TRIGGER | WR6007-1840-300-16 |
| 101 | SWITCH BUTTON | WR6007-1840-300-17 |
| 102 | SWITCH BOX | WR6007-1840-300-14 |
| 103 | NO.3 ROD | WR6006-1600-700-05 |
| 104 | SPONGE TUBE | |
| 105 | WIRE TRIGGER | WR6007-1840-700-14 |
| 106 | SCREW ST5*25 | GB845-85 |
| 107 | WR6006-1600-700-14 | |
| 108 | WR6001-1500-400-18-01 | |
| 109 | WR6006-1600-300-24 | |
| 110 | GASKET GB845-85 | |
| 111 | GASKET GB845-85 | |
| 112 | WR6001-1500-400-05 | |
| 113 | BEARING GB/T276-1994 | |
| 114 | RING Ø10 GB845-85 | |
| 115 | SCREW ST5*16 GB845-85 | |

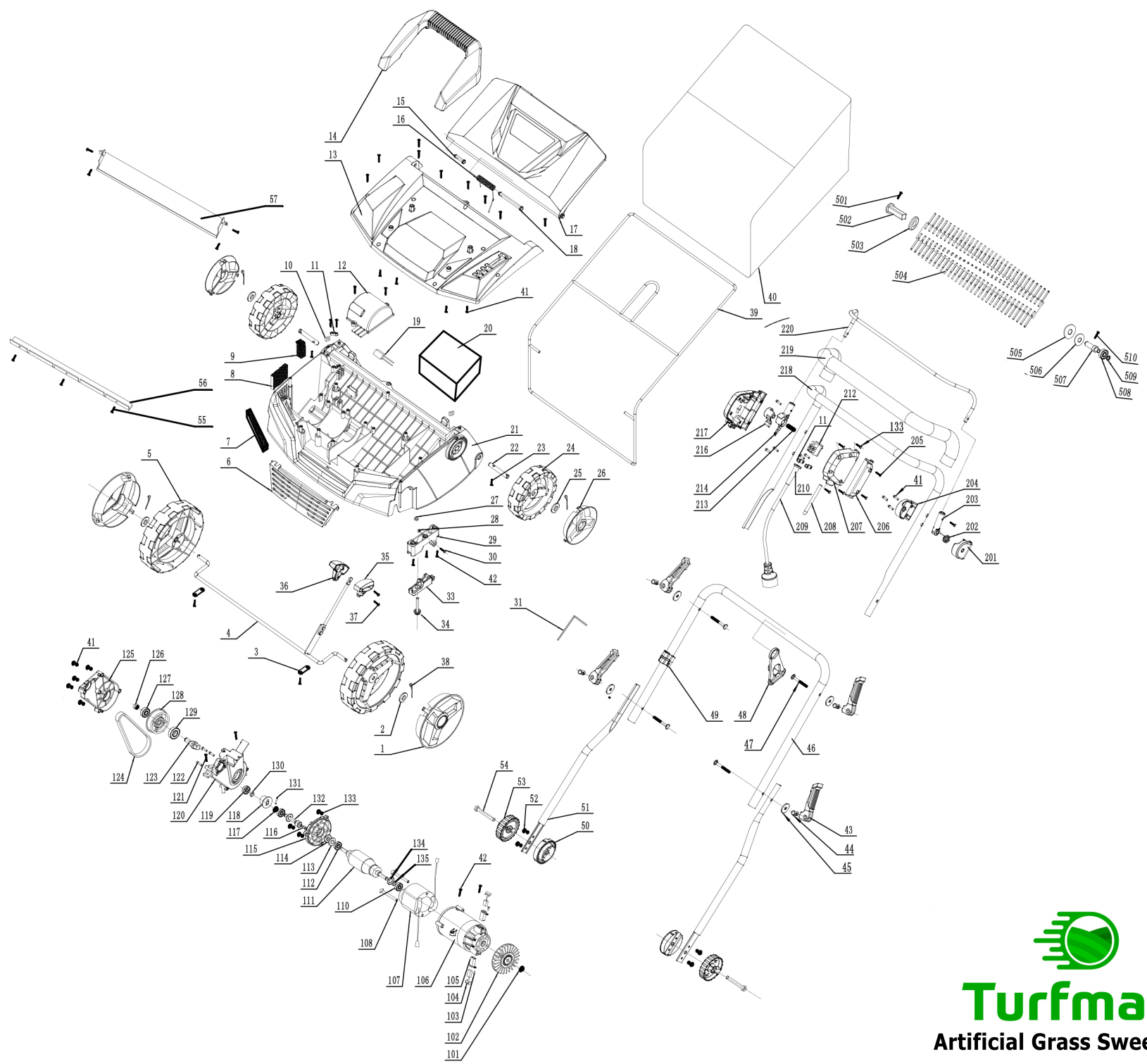

Turfmatic™
Artificial Grass Sweeper 380